

ez Cutter™

User Guide

ez Cutter™ works like a pen but with the convenience of cutting as you trace a template or other pattern, and ez Cutter™ is the only cutter with retractable swivel and fixed blades for safer handling and storage.

Use ez Cutter™ with any cutting mat and with many different brands of templates to quickly crop pictures or to cut hundreds of fun shapes. You can even use ez Cutter™ freehand without a template to cut any imaginable curvy shape.

ez Cutter™
does it all!

(see detailed instructions inside)

Crop
Pictures



Cut
Shapes

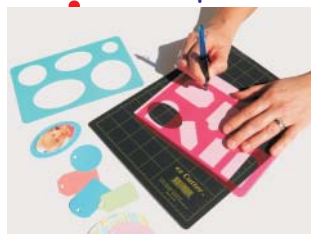

Straight Cuts
(with fixed blade)



Freehand Waves

Memories & Treasures

Kaysville, UT 84037

Tel: 801-593-9320 Fax: 801-546-6250

Email: ezcuttersales@msn.com

Website: myezcutter.com

Template Tracing with **ez Cutter's** Swivel Blade

Place your material onto your **ez Cutter** cutting mat. In this example the material is a photograph.

Any cutting mat will work but **ez Cutter** knives are designed to work best with **ez Cutter** mats.



Select a template and position it over the picture. **ez Cutter** knives work best with **ez Cutter** templates but they also work with some other brands of templates.

It's always a good idea to secure the outside edge of the photo to the template with 2 or 3 pieces of tape to keep them from slipping during cutting.



Hold the black slide portion of your **ez Cutter** knife like a pen with the tip of your thumb on the slide release button as shown. Also notice that the blade is not exposed or lock forward when tracing.

ez Cutter knives come with swivel and fixed type blades. Be sure to use a swivel type blade for tracing. Blade changing instructions are shown in your DVD and on the back of your knife package.



1. Move the nose of your knife to an empty spot on your cutting mat as shown.
2. Press the slide release button in firmly and then press downward on the slide. The knife blade will penetrate the cutting mat slightly.
3. Drag your knife about 1 inch along the mat in the direction you want to start tracing. In the picture, the direction is shown by the arrow. This procedure aligns your blade properly.

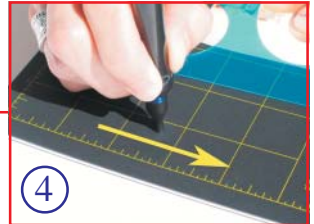

1. Position your **ez Cutter** knife perpendicular to the picture with the end of it's nose against the picture and the side of it's nose against the template edge as shown.
2. Press the slide button in firmly and then push downward on the slide. The slide will move down and the knife blade will cut through the picture and penetrate slightly into the mat.



Continue to press down lightly on the slide as you start tracing around the template in the direction that you previously aligned your blade.

Keep your perpendicular to the picture and don't tilt or rotate your hand. Just use arm motion to move your knife around the template.

Press down more on the slide if necessary until you see that your material is being cut. Thicker materials may require more than one pass to completely cut out the pattern shape.



Template Tracing Continued

Stop tracing and remove your knife when you see that the pattern is completely cut out. The finished shape that you cut will be about 1/8 inch smaller than the size of your pattern.



The **ez Cutter** blade will retract back into your knife as soon as you pull the knife away from the picture. When you remove your thumb from the slide release button, the slide will automatically lock into its retracted position for safer handling and storage.

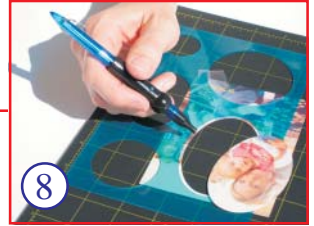

Blade Changing

Before starting, make sure that the blade is retracted back inside your knife. If the blade is exposed, press in the slide release button to automatically retract the blade.



Hold your **ez Cutter** knife in one hand and use your other hand to unscrew the nose piece on the knife by twisting it counter clockwise.



Remove the compression spring.



Carefully remove the blade assembly. Avoid touching the sharp blade.



To reassemble your knife, obtain a replacement blade (swivel #22702 or fixed #22703) then reverse the disassembly steps described above.

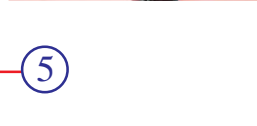

Freehand Cutting with **ez Cutter's** Swivel Blade

1. Hold the handle of your **ez Cutter™** knife in one hand and press in the slide release button with your other hand.
2. While the release button is pressed in, pull the slide forward until the blade locks in its fully exposed position. Be sure to use a swivel type blade for this procedure, a fixed type blade will not work properly.



1. Place your material onto a cutting mat. In this example the material is a photograph.
2. Hold your **ez Cutter™** knife like a pen against the photo and begin freehand cutting. In this example a wavy pattern is being cut.



Apply enough downward pressure until you see that you are completely cutting through your material. Continue cutting until your shape has been cut.



When you are finished, remember to press the slide release button in again to automatically retract the blade for safer handling and storage.



Straight Cutting with **ez Cutter's** Fixed Blade

1. Hold the handle of your **ez Cutter™** knife in one hand and press in the slide release button with your other hand.
2. While the release button is pressed in, pull the slide forward until the blade locks in its fully exposed position. Be sure to use a fixed type blade for this procedure, a swivel type blade will not work properly.



Hold your **ez Cutter™** knife like a pen against the item to be cut. In this example the knife is being used to cut open a package.



When you are finished, remember to press the slide release button in again to automatically retract the blade for safer handling and storage.

